

# GLIDELINE

GS47 SLIDING DOOR







# SPECIFICATION



## CONFIGURATIONS

TRACK, 2 TRACK, 3 TRACK, QUAD TRACK

## SIGHTLINES

INTERLOCK 47 MM

## GLAZING

MAX. 36 MM, MIN. 26 MM

## MAXIMUM SASH DIMENSIONS

WIDTH (L) 2500 MM, HEIGHT (H) 3000 MM

## MAXIMUM SASH WEIGHT

SLIDE 280 KG LIFT & SLIDE 300 KG

## COLOUR

POWDER COATING RAL FINISH  
STANDARD 7016M, 9005M, 9016G  
AVAILABLE IN 150+ RAL FINISHES  
TEXTURED FINISH AVAILABLE  
SPLIT COLOR FOR INTERIOR/EXTERIOR  
WOOD EFFECT POWDER COATING  
ANODIZED ALUMINIUM

### BFRC Rating

kWh/(m<sup>2</sup>.yr)

≥20	A ++
>10 to 20	A +
0 to <10	A
-10 to <0	B
-20 to <-10	C ✓
-30 to <-20	D
-50 to <-30	E

Double glazing

### BFRC Rating

kWh/(m<sup>2</sup>.yr)

≥20	A ++
>10 to 20	A +
0 to <10	A
-10 to <0	B ✓
-20 to <-10	C
-30 to <-20	D
-50 to <-30	E

Triple glazing

## FEATURES

U value (I)		Double glazing Uw from 1.4 (W/m <sup>2</sup> K)	Triple glazing Uw ≥ 1.2 (W/m <sup>2</sup> K)
Acoustic insulation		Rw up to 40 dB	
Air permeability		Class 3* / 4**	
Water tightness		Class 7A	
Wind resistance		Class C5* / C2**	
Security test		Passed	

Double glazing Ug=1.0 / Triple glazing Ug=0.7

(I) Two sashes 5 m x 3 m

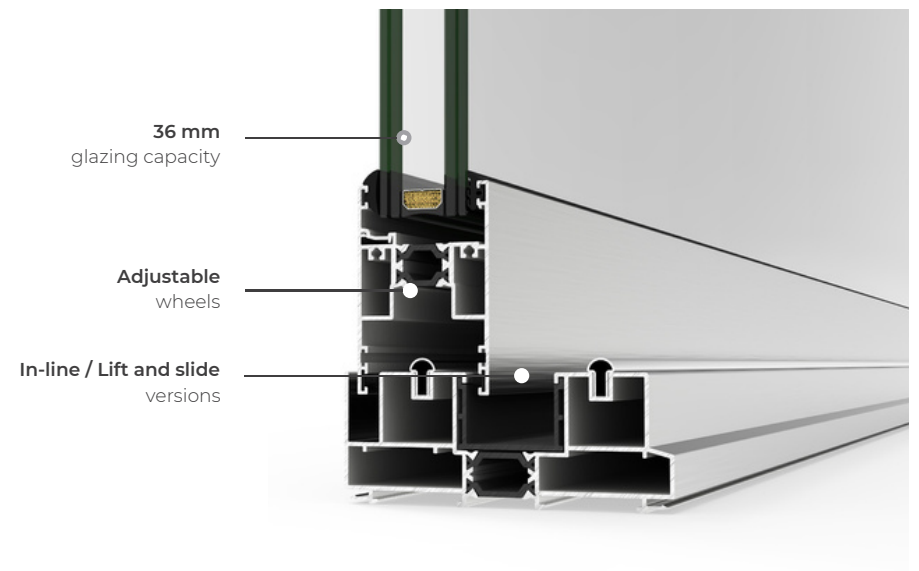

# CONFIGURATIONS



2 PANE

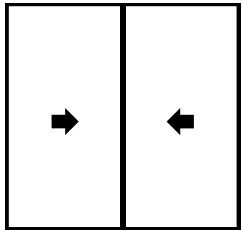

3 PANE

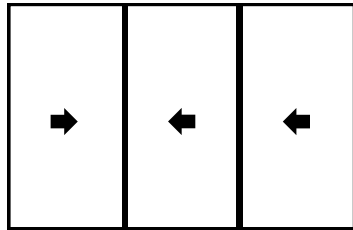

4 PANE

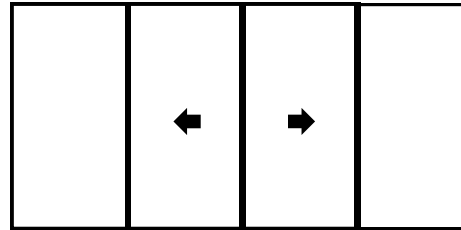

QUAD TRACK

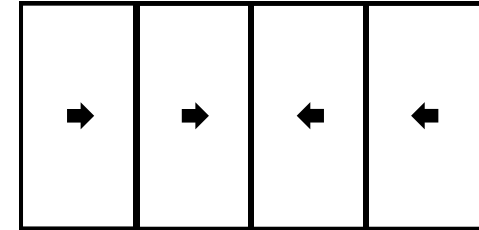

1 PANE POCKET

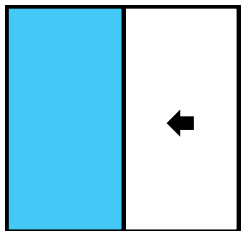

2 PANE POCKET

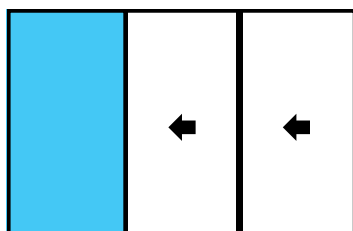

2 PANE POCKET

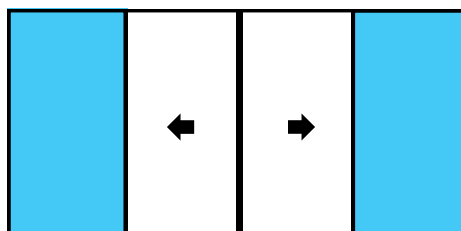

3 PANE POCKET

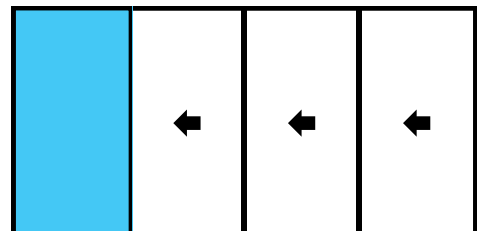

# CONFIGURATIONS



## IN-LINE SLIDER

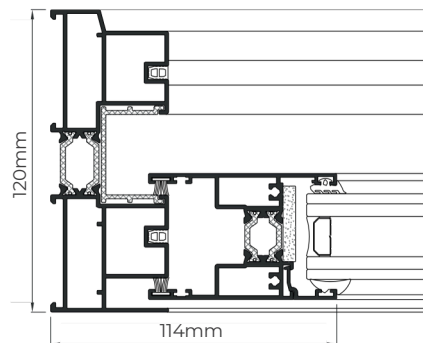

## LIFT & SLIDE

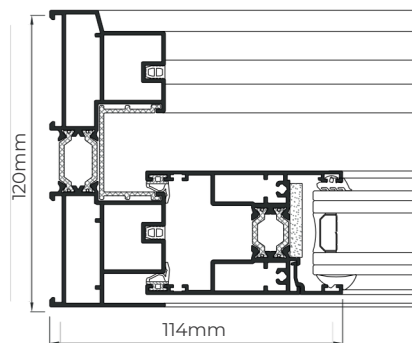

In-line Slider



Lift & Slide

## DRAINAGE SOLUTIONS

### Hidden Drainage

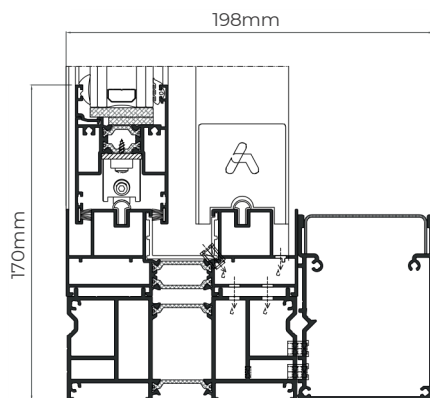

### 250 mm Subcill

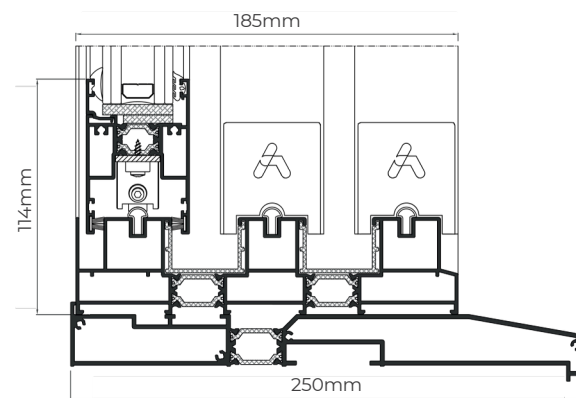

## HEAD EXTENSION - 38 mm

### Double Track

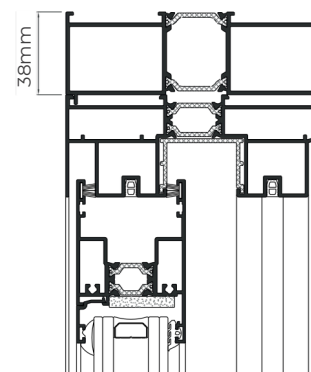

### Triple Track

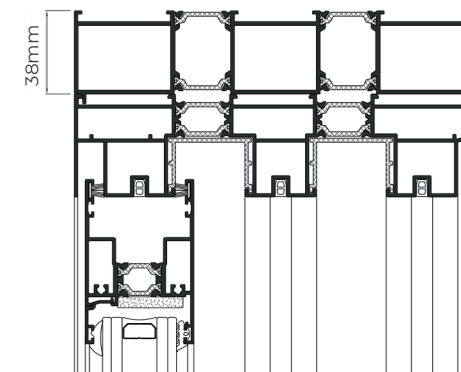

# HARDWARE



**GREY 7016**   **BLACK 9005**   **WHITE 9016**   **LIGHT SLIVER**   **DARK SLIVER**   **CUSTOM RAL**

Thermally broken minimalist sliding system that provides maximum luminosity with a minimal aluminium interlock profile. It has an elegant design only 47 mm sightline and offers the possibility of an inlaid closing system and of hiding the frame along the perimeter.

Choose from a range of lever handle or a flush handle providing a sleek minimalist design. Only available with no keyed locking inside or outside.



**FLUSH HANDLE**



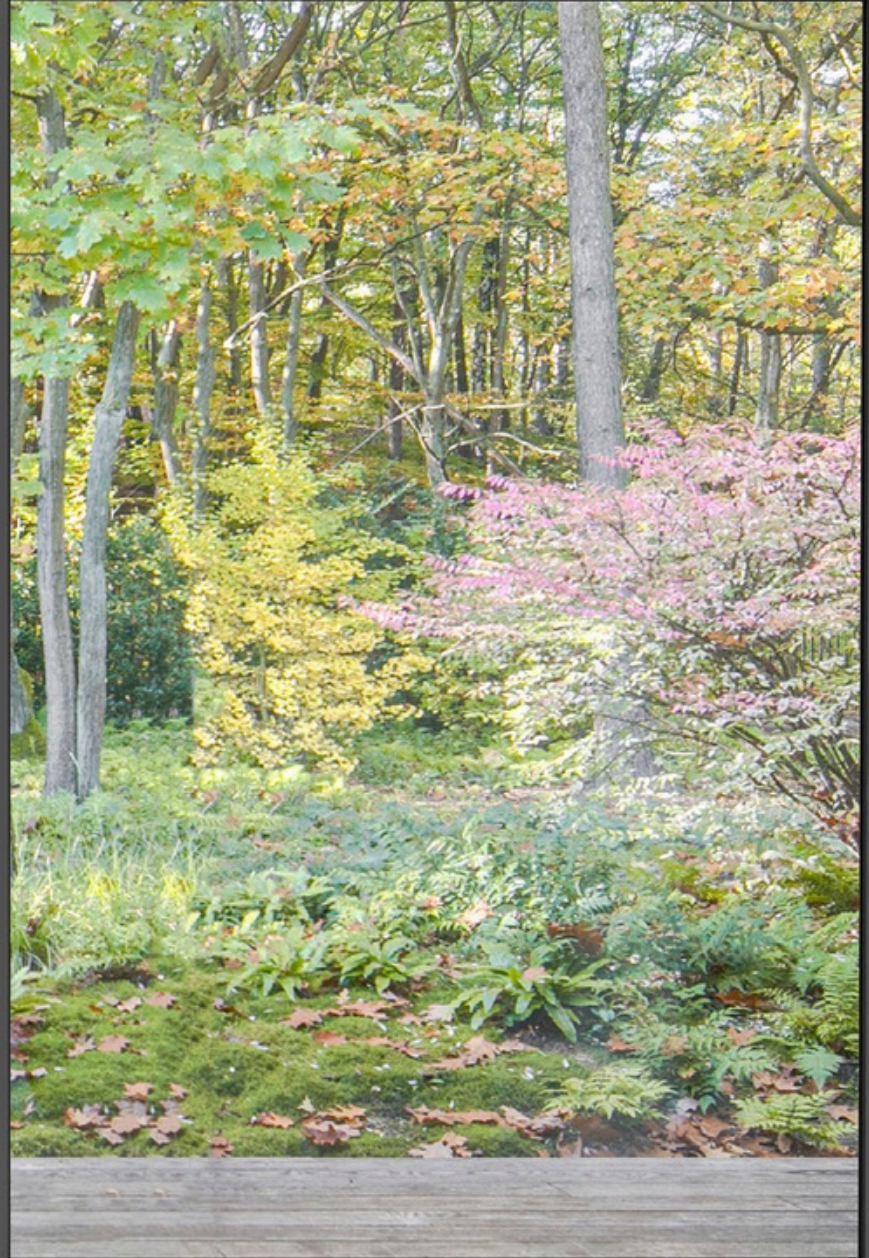
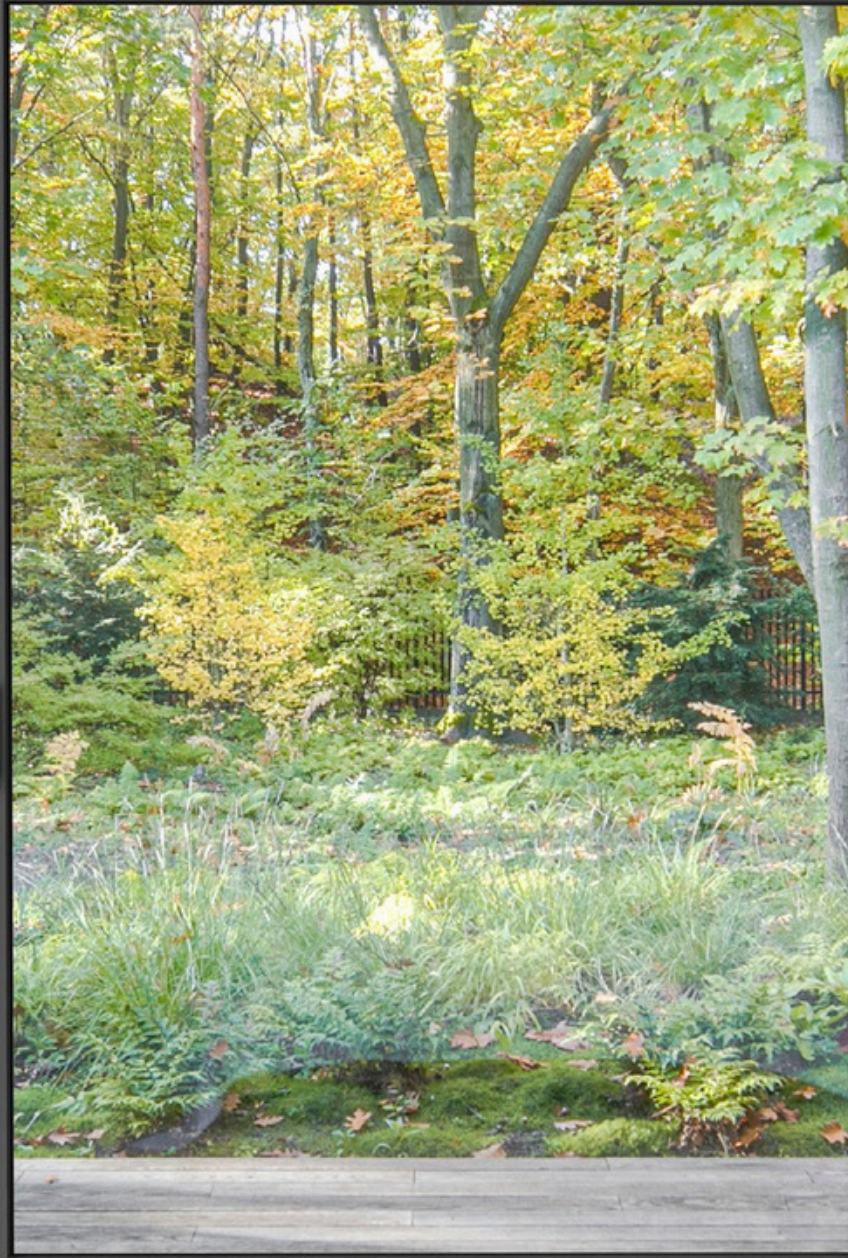



# GLIDELINE GO

KEEP UP TO DATE WITH YOUR  
GLAZING PROJECTS WITH  
GLIDELINE GO



**Introducing GlidelineGO** – the ultimate system designed to streamline your glazing order management process. With GlidelineGO, customers and trade partners can effortlessly create, track, and manage orders, while enjoying the convenience of approving drawings and making payments directly within the app.

Efficiency and ease-of-use are at the heart of GlidelineGO. Whether you're an architect, contractor, or glazing professional, this powerful app empowers you to take control of your glazing projects, ensuring a seamless experience from start to finish.







# GLIDELINE