

GLIDELINE

SERVING WINDOW





SPECIFICATION



CONFIGURATIONS

- GAS
- SLIDING
- BIFOLD

SASH SIGHTLINES

- **GAS** - 49MM SASH
- **SLIDING** - 15MM
- **BIFOLD** - 110MM

GLAZING

MAX. 48 MM, MIN. 25 MM

MAXIMUM SASH DIMENSIONS

- **GAS** - WIDTH (L) 1800MM, HEIGHT (H) 1500MM
- **SLIDING** - WIDTH (L) 2500MM, HEIGHT (H) 1800MM
- **BIFOLD** - WIDTH (L) 1200MM, HEIGHT (H) 1800MM

MAXIMUM SASH WEIGHT

GAS - 70 KG / SLIDING - 320 KG / BIFOLD - 120KG

COLOUR

POWDER COATING RAL FINISH
 STANDARD 7016M, 9005M, 9016G
 AVAILABLE IN 150+ RAL FINISHES
 TEXTURED FINISH AVAILABLE
 SPLIT COLOR FOR INTERIOR/EXTERIOR
 WOOD EFFECT POWDER COATING
 ANODIZED ALUMINIUM

U VALUE (W/M2K) >

1.2

SOLAR HEAT REFLECTION >

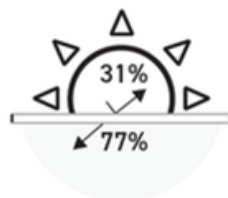

LIGHT TRANSMISSION >

FEATURES		
Transmittance		$U_w \geq 1.2$ (W/m ² K)
Acoustic insulation		Rw up to 41 dB
Air permeability		Class 4
Water tightness		Class E750
Wind resistance		Class C3

BFRC Rating

kWh/(m².yr)

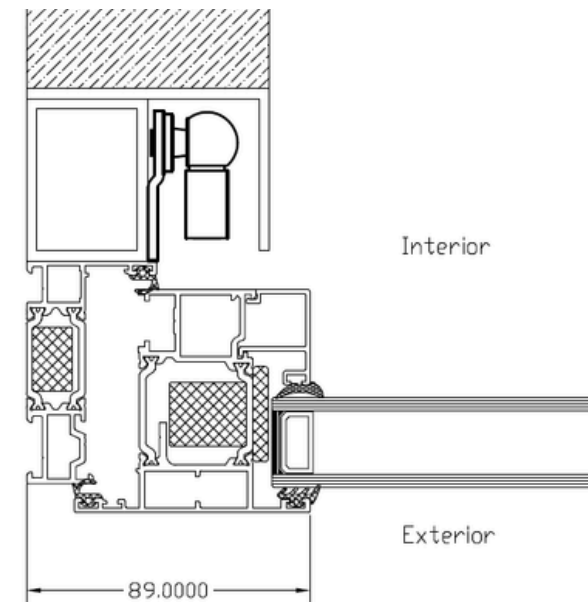
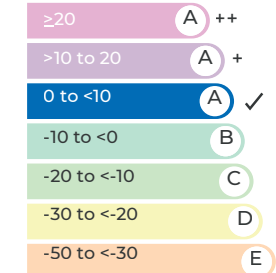

CONFIGURATIONS



GAS

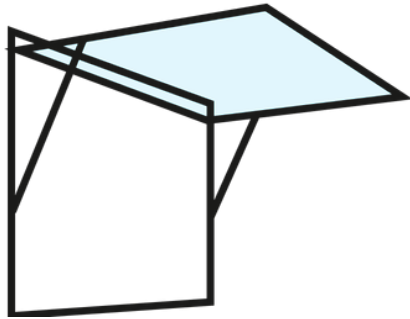

SLIDING

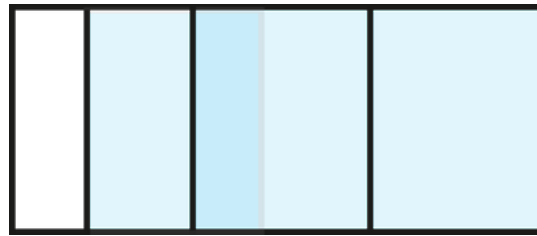

BIFOLD

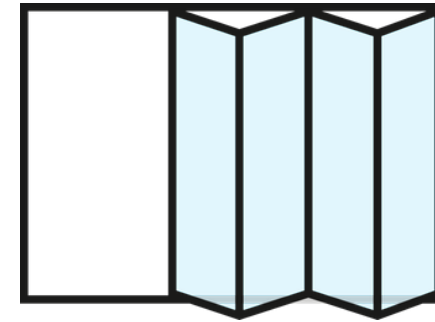





GLIDELINE